

📍 Phang Nga

Phang Nga 7408

🛏 7 🚿 7 👤 18



The ultimate tropical beachfront playground, 7-bedroom Villa Tievoli faces gorgeous Natai Beach - 10 kilometres of pristine sand less than half an hours drive north of Phuket airport. This superb modern villa is fully staffed and features multiple entertaining, lounging and dining areas. Suitable for extended families, weddings and events, the villa comes with an spa, sauna, steam room and beauty salon for on-call pampering , a 25-metre infinity pool and a large sea-facing garden. Fill the days with paddleboarding or kayaking and catch the kaleidoscopic sunsets every evening from the sleek poolside bar.

Its getting harder to find in Thailand, but in the Natai Beach area the landscape remains rural and people lead a quiet, traditional way of life. Natai - whose soft, white, virtually deserted sands stretch for five-kilometres along the shores of the Andaman Sea - lies in the south-west of Phang Nga province, just over the bridge from Phuket. Even at the height of the season there are just a sprinkling of people on the beach, and absolutely no commercial activity. The rickety old pier that you can see from the villa is probably 100 or more years old, once a launching point for transporting tin (the main industry in the region before tourism).

You can drive for miles along the road that runs parallel to the beach, and at one point youll reach a public pier where, in the late afternoon, the locals come to relax while fruit and snack vendors set up their stalls. If youre on the search for dining outside the villa, you could try the well-regarded Aleenta resort or the new Iniala villa resort, which boasts a three Michelin-starred chef. Otherwise, the villa manager can direct you to some of the excellent local seafood restaurants where youll get to sample some authentic Thai flavours.

The nearest town is Kekkloy, about five kilometres away, where you can find basic provisions and banking services. Its a typical Thai town, lined with shop-houses, that so far remains free of any tourist activity. Those wishing to indulge in some golf, shopping or sightseeing can drive over the bridge to Phuket. It takes about an hour by car to reach the main resort areas and Phuket City. For diving and snorkelling, day trips to the Similan islands may be arranged, with boats launching from Khao Lak, about 45 kilometres to the north.

Features and amenities

Location

Sava Beach Villas, Natai Beach, Phang Nga, Phuket, Thailand.

Capacity

14 adults plus 4 kids (7 bedrooms: 4 king bedded rooms, one of which has additional single bed; 1 queen room with an additional single bed; 1 twin; and a bunk room for 4 kids).

Living areas

Indoor living room; indoor dining room seating 14; outdoor lounge, dining, bar and barbecue area; guest kitchen; sun deck, home entertainment room, kids' play room/bunk room.

Pool

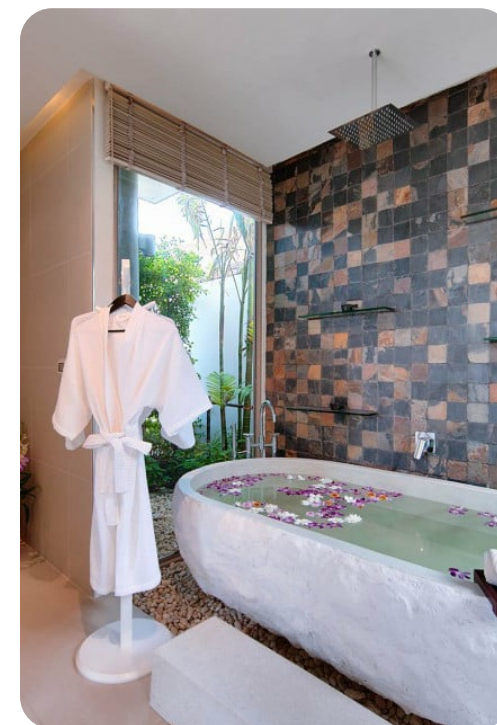

25m x 6m x 1.3m

Staff

Villa manager/concierge; villa attendants; two full-time chefs; two full-time spa therapists; estate security staff. Babysitters are available on request (additional charge).

Dining

The chefs specialise in traditional Thai cuisine and seafood. Daily continental breakfasts included.

Communication

Complimentary WiFi throughout the villa.

Entertainment

iPod dock/speakers; satellite TV; pool table; digital film and music library; Sony PlayStation.

For families

Kids play room; baby cot; kids library; stand-up paddleboards; single and double kayaks; swimming pool toys on request.

Spa, gym and yoga

Use of in-house spa with sauna, steam room and beauty salon where treatments from a spa menu can be arranged (charged extra). The villa offers three complimentary treatments from the spa menu offered per night of stay (to be used by 1 up to 3 guests); and complimentary use of estate's well-equipped gym.

Transport

Complimentary 1 x airport pickup.

Weddings and events

Events for up to 80 people seated and 120 standing can be arranged at Tievolo with prior notice (event fee applies).

Additional facilities

Pool table; water sports (kayaks and paddleboarding); bicycles; safety deposit boxes.

Property area

917 sqm (villa); 2,290 sqm (land).



The layout

Indoor living

- Spacious lounge
- Glass encased, 12-seater dining room
- Guest kitchen
- Comfortable home theatre room with pool table
- In-house spa with sauna, steam room, massage tables and beauty salon

Outdoor living

- 25m infinity pool
- Outdoor cocktail bar and lounge area
- Canopied barbecue dining area seating 14
- Relaxation areas and large pool sun deck
- Manicured gardens and beachfront lawn

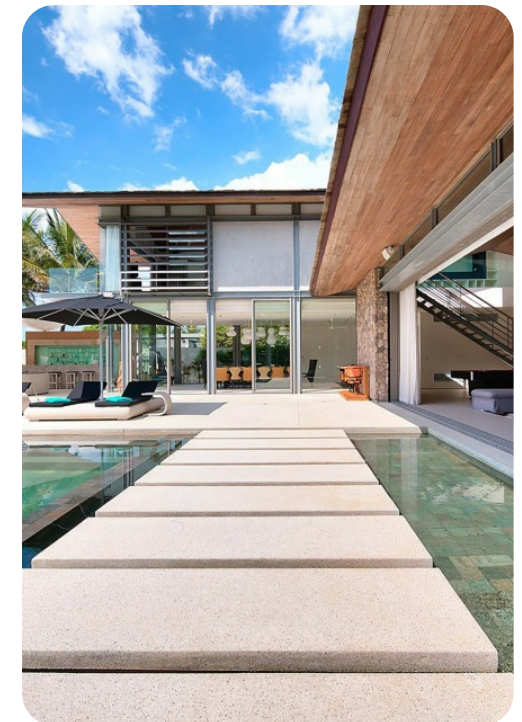
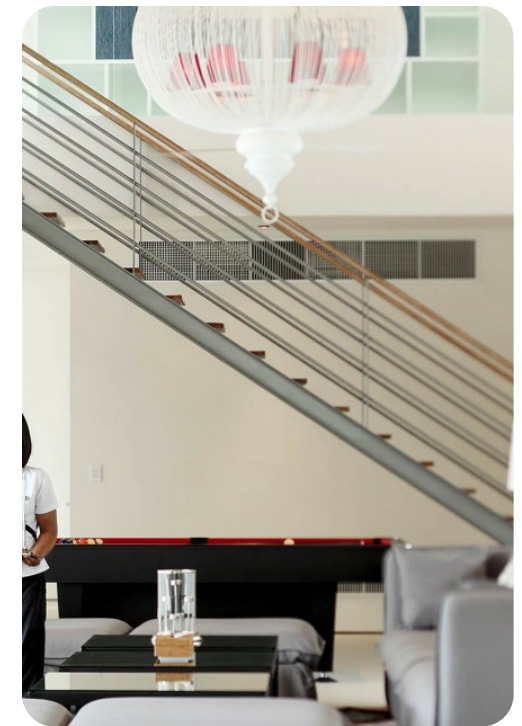

The rooms

Master bedroom

- Two master suites - one ground floor and one first floor - with sea views, king-size beds, floor-to-ceiling windows and ensuite bathrooms.
- Ceiling fan, air-conditioning, flat-screen TV

Guest bedrooms

- Four guest bedrooms - two ground floor and two first floor - with a mix of king, queen and twin beds
- First floor bedrooms with ensuite bathrooms
- Ground floor bedrooms share a bathroom with a terrazzo bathtub.
- Ceiling fan, air-conditioning, flat-screen TV

Kids bedroom

- Kids room sleeps 4 in two sets of bunk beds
- TV, PlayStation and many toys and books
- Ensuite bathroom with small-sized sinks and toilet

Location

Villa Tievoli is one of seven exclusive private villas on the Sava Beach Villas estate, which fronts the beautiful Natai Beach, a 10-kilometre stretch of pristine sand to the north of Phuket Island. The villa offers a tranquil hideaway in a rural setting but is only an hour away from the buzz of Phuket's beach resorts and less than half an hour from the island's international airport. Natai Beach is perfect for paddleboarding, kayaking and swimming and The Aleenta and Iniala Beach resorts, both just along the sand, offer award-winning dining.

